

Ambiwall

WALL CLADDING 003 - 1/2" BACKLIT

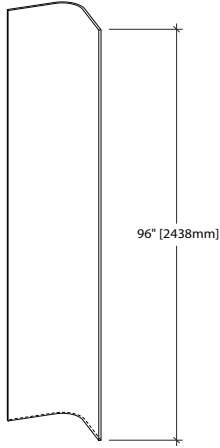

AXONOMETRIC

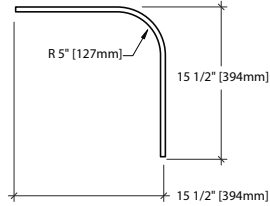

TOP

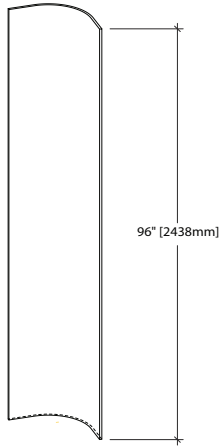

AXONOMETRIC

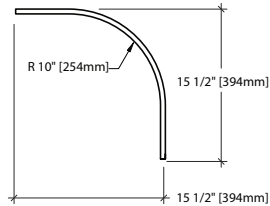

TOP

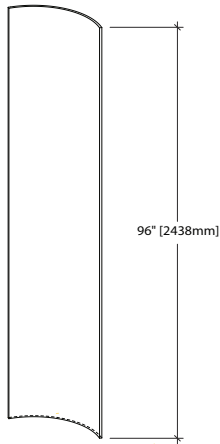

AXONOMETRIC

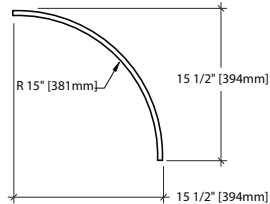

TOP

P2 - INSIDE CORNER WALL PANEL - 5" RADIUS

TO BE SPECIFIED

Product #: **ENP-C03-P2-5R**

Material:

- Color (see color guide)
- Pattern Style (see pattern guide)
- Pattern Face - Front or Back
- Finish - Matte standard or Semi-gloss

Height Dimension:

96" Standard (up to 143" available)

Notes:

- (1) - Panel thickness is 1/2";
- (2) - Metric conversions are approximate;
- (3) - All dimensions will be rounded to the nearest 1/8".

P2 - INSIDE CORNER WALL PANEL - 10" RADIUS

TO BE SPECIFIED

Product #: **ENP-C03-P2-10R**

Material:

- Color (see color guide)
- Pattern Style (see pattern guide)
- Pattern Face - Front or Back
- Finish - Matte standard or Semi-gloss

Height Dimension:

96" Standard (up to 143" available)

Notes:

- (1) - Panel thickness is 1/2";
- (2) - Metric conversions are approximate;
- (3) - All dimensions will be rounded to the nearest 1/8".

P2 - INSIDE CORNER WALL PANEL - 15" RADIUS

TO BE SPECIFIED

Product #: **ENP-C03-P2-15R**

Material:

- Color (see color guide)
- Pattern Style (see pattern guide)
- Pattern Face - Front or Back
- Finish - Matte standard or Semi-gloss

Height Dimension:

96" Standard (up to 143" available)

Notes:

- (1) - Panel thickness is 1/2";
- (2) - Metric conversions are approximate;
- (3) - All dimensions will be rounded to the nearest 1/8".

Made in the U.S.A.

For more information, please visit us at www.evansandpaul.com or call 1-516-576 0800
©2009 Evans & Paul Unlimited Corp. All Rights Reserved.