

MODEL #: ENP-S201-24

# SINK SERIES 201

## 24" RECTANGULAR VESSEL SINK



The Sink Series 201 is a rectangular vessel-style sink designed for in-counter installation.

### DIMENSIONS

Nominal Overall Dimensions:

24" x 17-1/2"

Bowl Inside Dimensions:

21" wide, 12-1/2" front to back, 5" deep

This product can be customized to your dimensional requirements.

For custom orders, use Model# PODS-S201-X

### MATERIAL

Dupont Corian Construction. Minor cuts or scratches can easily be removed. Due to the structure of the Corian material, sinks resist stains, are easy to clean, and simple to renew.

### COLORS

Standard colors are Glacier White, Bone, Bisque and Dove. Available in most colors of Dupont Corian as a custom option. For a complete listing of available colors, please see our color guide sheet.

### FINISHES

Standard finish is Matte, Semi-gloss is also available.

### TO BE SPECIFIED

Product #: **ENP-S201-24**

Faucet:

Drill Pattern <sup>2</sup>

Material:

Color (see color guide)

Finish - Matte standard or Semi-gloss

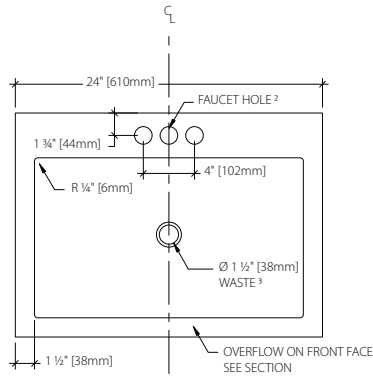

TOP

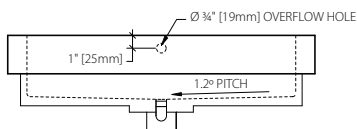

FRONT

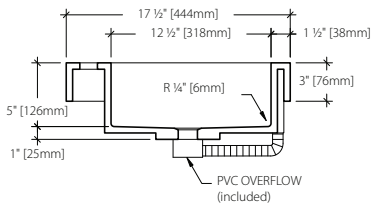

SECTION

#### Notes:

- (1) - Dimensions can be customized by using Model# ENP-S201-X;
- (2) - Faucet hole patterns of 4" centers (as shown), 8" centers, or single hole available;
- (3) - All drain holes are nominally 1 3/4" (45mm) in diameter and accept all standard drain hardware;
- (4) - Metric conversions are approximate;
- (5) - All dimensions will be rounded to the nearest 1/8".

Made in the U.S.A.

For more information, please visit us at [www.evansandpaul.com](http://www.evansandpaul.com) or call 1-718-661-1585  
 ©2007 Evans & Paul Unlimited Corp. All Rights Reserved.